

### INSTALLATION

The M6 (#316 Stainless Steel) Housings are intended to be mounted in or on an enclosure product. Installation should be performed by a qualified technician and adhere to applicable regulatory codes. These devices are for mounting on the flat surface of enclosures having the same type environmental ratings.



**NOTE: Special care should be taken to shield sensitive components from metal shavings and/or debris**

All installations:

- 1) Mark areas to be removed and cut panel opening.
- 2) Deburr any sharp edges.
- 3) Mount the housing using supplied hardware.
  - a. Hardware applicable mounting surface thickness of .059" - .250.
  - b. Hardware torque specification 10in-lb.

On units configured for optional AC power:

- 1) Connect outlet device as per code. *Note: It is the responsibility of the installer to ensure adequate separation of high and low voltage circuits in the end-use product.*

### MECHANICAL SPECIFICATIONS

Housing: Stainless Steel base/cover  
 Insert Material:: Acrylic UL 94HB

### ELECTRICAL SPECIFICATIONS

Low voltage (data), limited to 30 VDC  
 High voltage supply (for computer use only)  
 120 VAC, 15A (UL), 5A (CSA)  
 230-240 VAC, 16A (CE only)

### APPROVALS

**UL LISTED:**

**Housing only:** E488493 (TYPE 4X, IP69K)

**Assembled:** E207344 (TYPE 4X, IP69K)

**CSA:** LR110845 (not for interrupting circuit)

**CE:** EN61010/EN60950

### ENVIRONMENTAL RATING

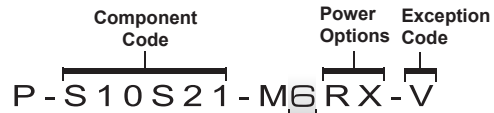

**First letter refers to housing size only.  
 Numeral refers to the environmental ratings below.**

**6 =UL TYPE 4X (IP69K)**

### QUESTIONS

For questions or technical support, please contact us at 1-800-280-9517.

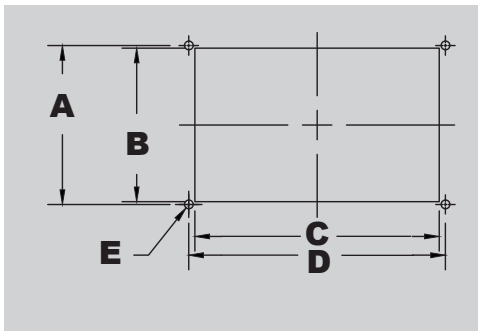

### MOUNTING DIMENSIONS INCHES (MM)

HOUSING CODE	A	B	C	D	EØ
M6	3.25 ± .004 (82.6 ± 0.1)	3.14 ± .010 (79.8 ± 0.2)	5.00 ± .010 (127.0 ± 0.2)	5.25 ± .004 (133.4 ± 0.1)	Ø0.18 = .010 (4.6 = 0.2)